

FOR BEST CONDITIONS.  
SINCE 1900.



**The leading  
intelligent  
system for  
the concrete  
industry.**

# Content

Introduction

Brand history

Solutions

The complete system

Rack System

ProAir Circulation System

ProCure Concrete Curing  
System

Sound Protection & Dust  
Extraction

Pallet Buffer & Mould Storage

Assembly

Service

Values

# ROTHO is the reliable partner for best conditions in the concrete industry.

## For Best Conditions. Since 1900.

For more than 70 years, we have been providing solutions for the concrete and brick industry worldwide - in constant awareness of the competitive pressure from our customers and their ongoing efforts to increase the effectiveness of their plants. Our ROTHO systems are developed to increase production levels and prevent downtimes while protecting the environment and employees. The production in our own factory in Germany guarantees a high quality standard and great flexibility. Together we create ideal conditions for high-quality products. The history of our company spans over four generations and ties in with the Siegerland metal industry. Founded by Robert Thomas in 1897, the company began with tool and fixture construction for the local industry. Later ROTHO expanded its range to include sheet metal products for storage and transportation systems. In the 1950s, the company developed the first egg-layer machines for concrete blocks and pavers and in the 1970s, ROTHO revolutionized the concrete block industry with the world's first industrially manufactured curing racks.

## **This is ROTHO**

- Founded around 1900
- Traditional family business in its 4th generation
- Long-standing, solid business relationships defined by its personal atmosphere
- High integrity
- Production in Germany
- Innovative and qualified engineering
- The best solutions for the concrete block industry worldwide





Headquarters ROTHO, Neunkirchen



Production ROTHO, Neunkirchen





Main Office Robert Thomas Group,  
Neunkirchen



Shipping and Logistics site Robert Thomas Group,  
Burbach-Wahlbach



# Tradition and innovation.

## 1897 Foundation

Robert Thomas founds the company as a metal manufacturer for the industrial companies in the Siegerland region.

## 1920er Milk cans, wheelbarrows, sheet metal products

ROTHO expands its metal goods production and becomes, among other things, a global player in the manufacture of high-quality milk cans.

## 1950 Egg-layer machine

Market launch of the first egg-layer machines for concrete blocks and pavers

## 1970 Curing Racks

ROTHO is the first company to develop Curing Racks for the concrete block industry on an industrial scale.

## 1992 Sound Protection

Developement of the first ROTHO Sound Protection Cabins.

## **1997** Dust Extraction

First implementation of a Dust Extraction System with replacable filter units to reduce dust in the machine cabin and on the board brush.

## **2003** Air Circulation

The high-performance ProAir Circulation System was developed to meet the increasing quality requirements.

## **2010** Big Chamber

Use of the first climate Big Chamber for curing concrete products.

## **2015** ProCure

Introduction of the ProCure Curing System for the best and most uniform concrete block quality, 365 days a year.

## **2020** ProCure with Heat Exchangers

Further development of the ProCure system to be able to use a wide variety of sustainable energy sources.

# The leading system for the concrete industry.

## System Components:

- 01 Rack System
- 02 ProAir Circulation System
- 03 ProCure Concrete Curing System
- 04 Sound Protection & Dust Extraction
- 05 Pallet Buffer & Mould Storage

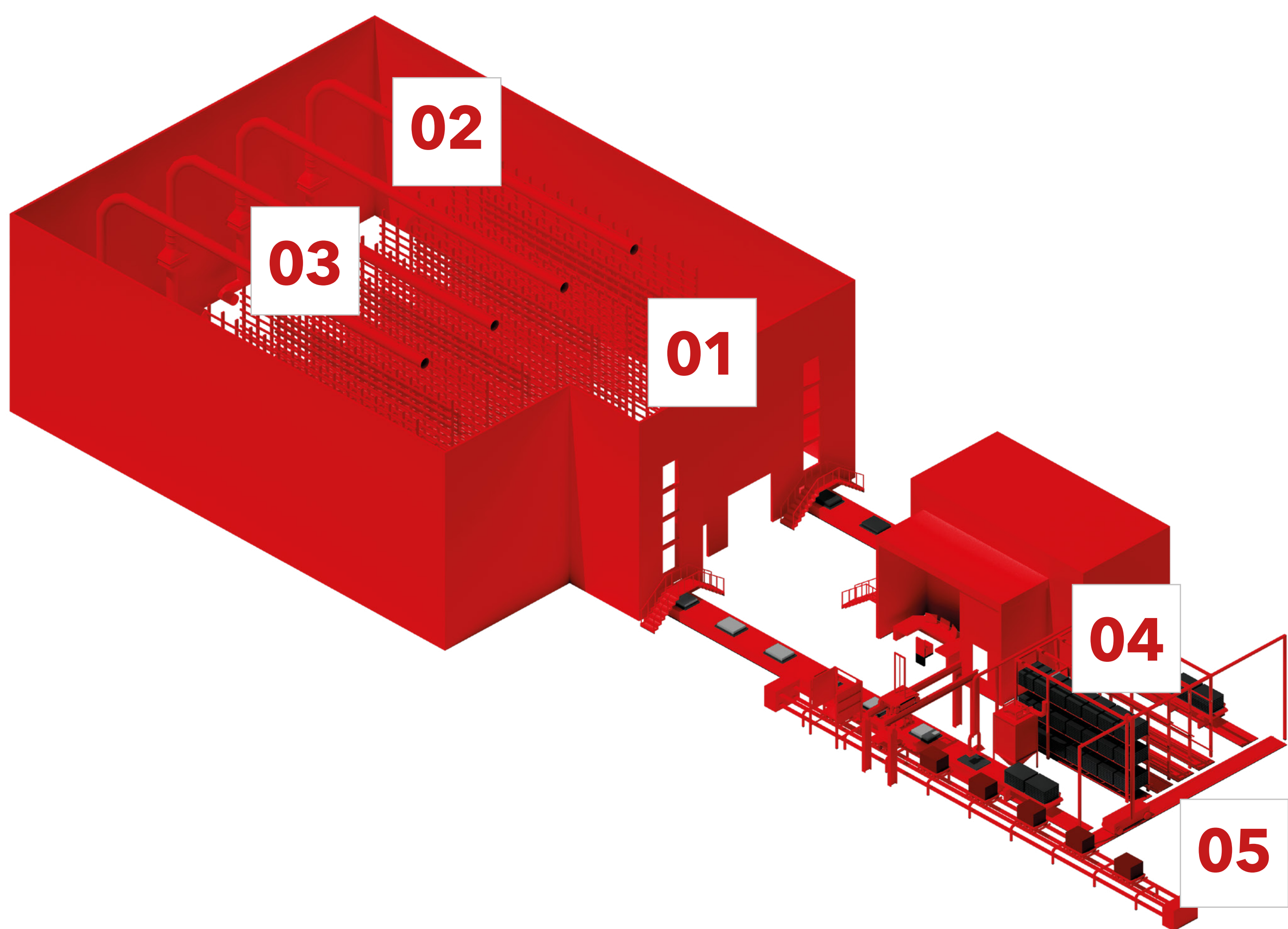

## The complete system for concrete curing

With its complete system for the concrete block industry, ROTHO is a reliable partner for concrete block producers and manufacturers of concrete block machines. Systems from ROTHO guarantee a smooth process and the best conditions for the concrete products and the employees in your company.

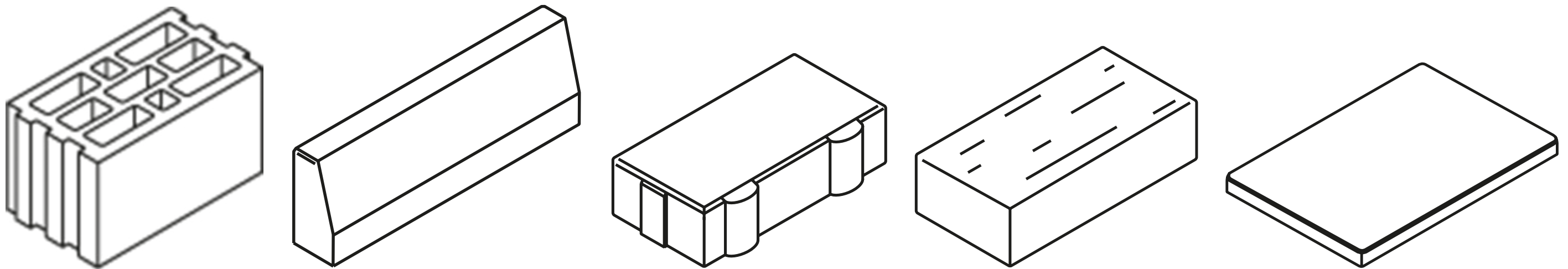



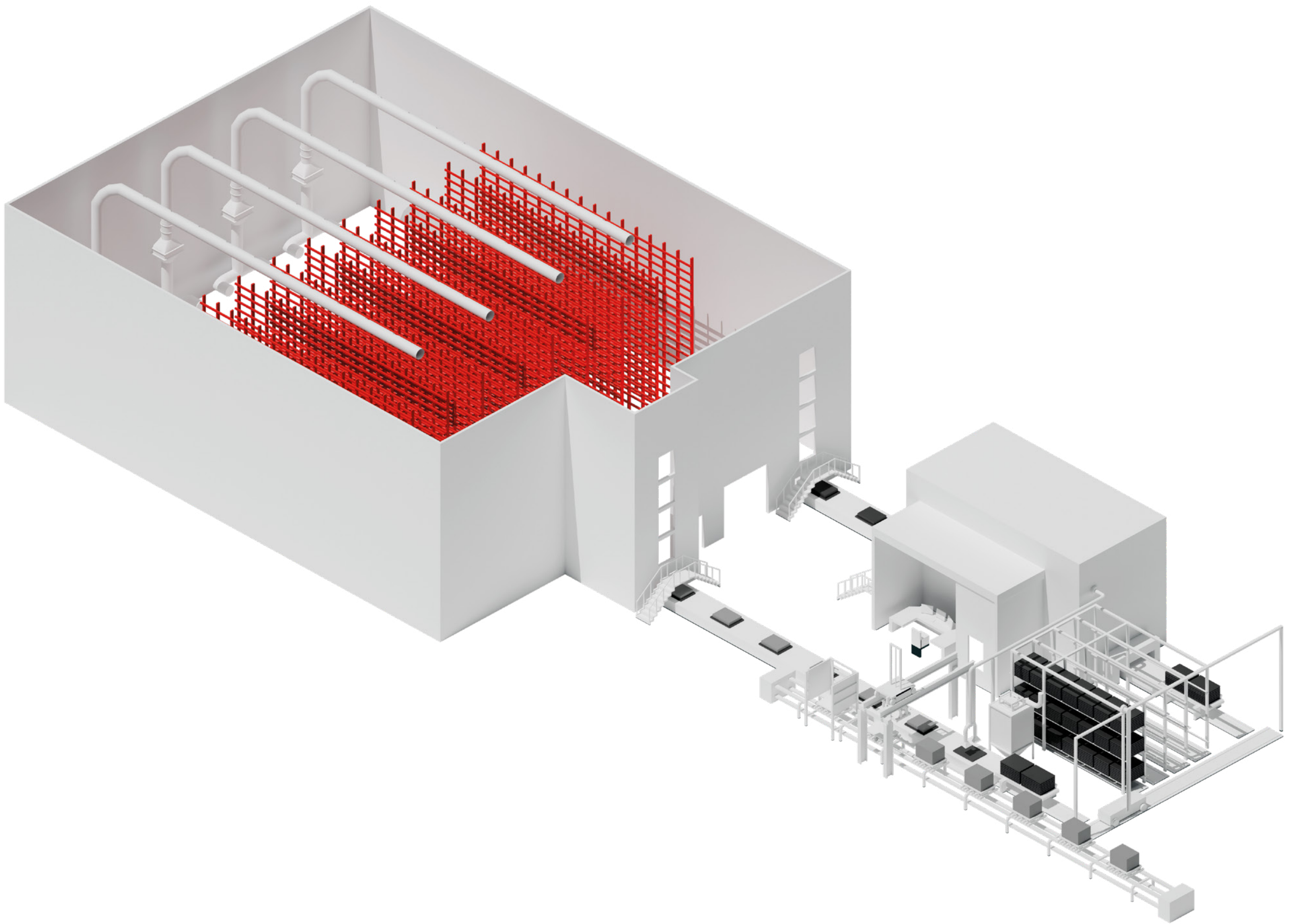

# Rack System

## Product advantages

- Quality design and production in our own factory in Germany
- Proven construction with experience from more than 2,500 installations worldwide
- Prepared for sensor and measurement technology
- From standard construction kits to individual solutions all from one source
- Prepared for air circulation and concrete curing system ProCure

## Highlights



### Indoor Curing Rack

Installation within existing building

The standard version individually adapted to the requirements of the system. Expandable and particularly economical. Optionally with safety profiles.



## Highlights



### Outdoor Curing Rack

With integrated outer cladding

All-in-one solution, including roof & wall cladding.  
Various roof shapes can be realized.



## Highlights



### Clip-In Technology

Fast, safe, and easy assembly

The special design prevents the accumulation of concrete residue on the support profiles.



## Highlights

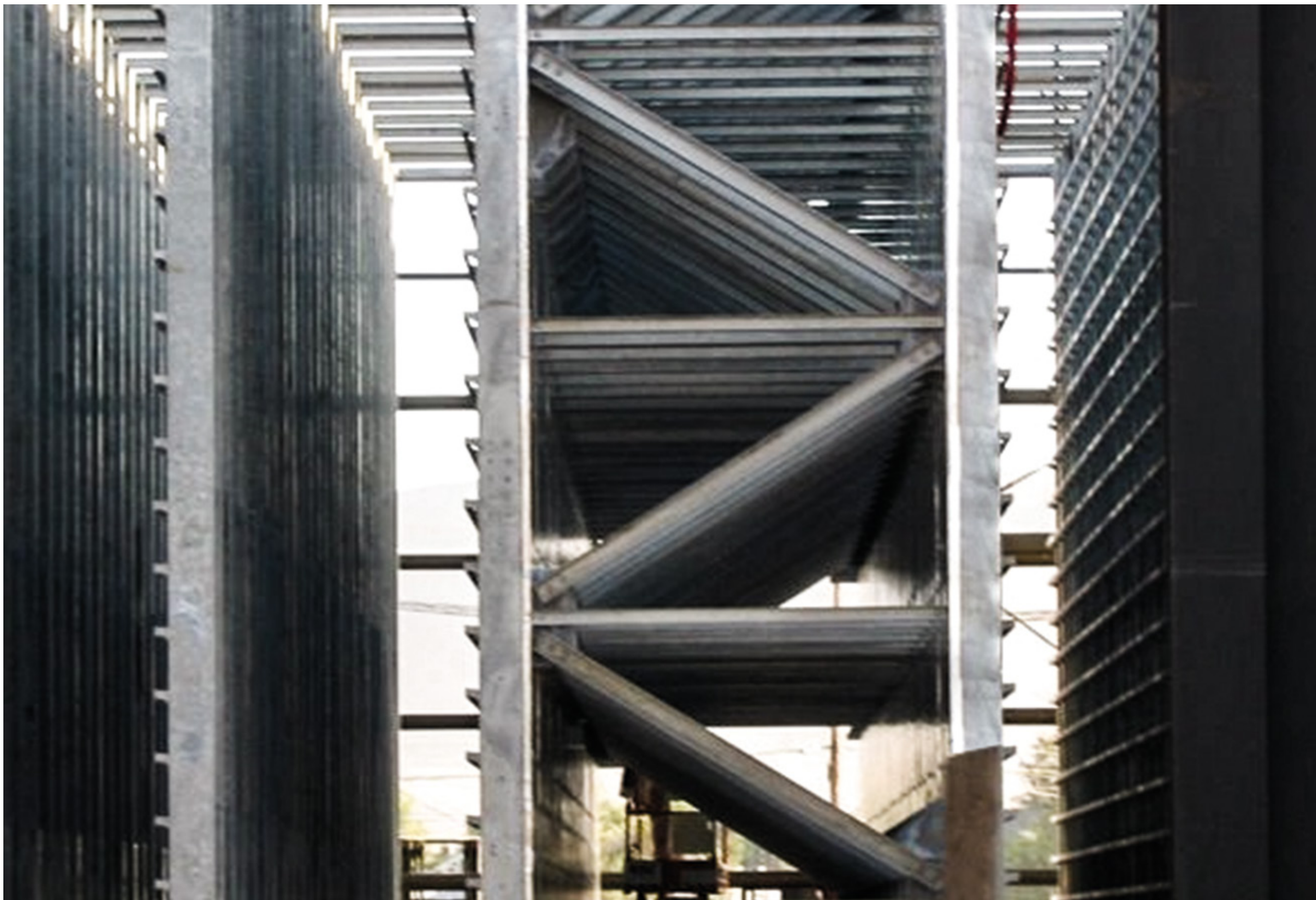

### Earthquake-Proof Design

Special robust design

Customized special designs enable safe system operation even in earthquake zones.



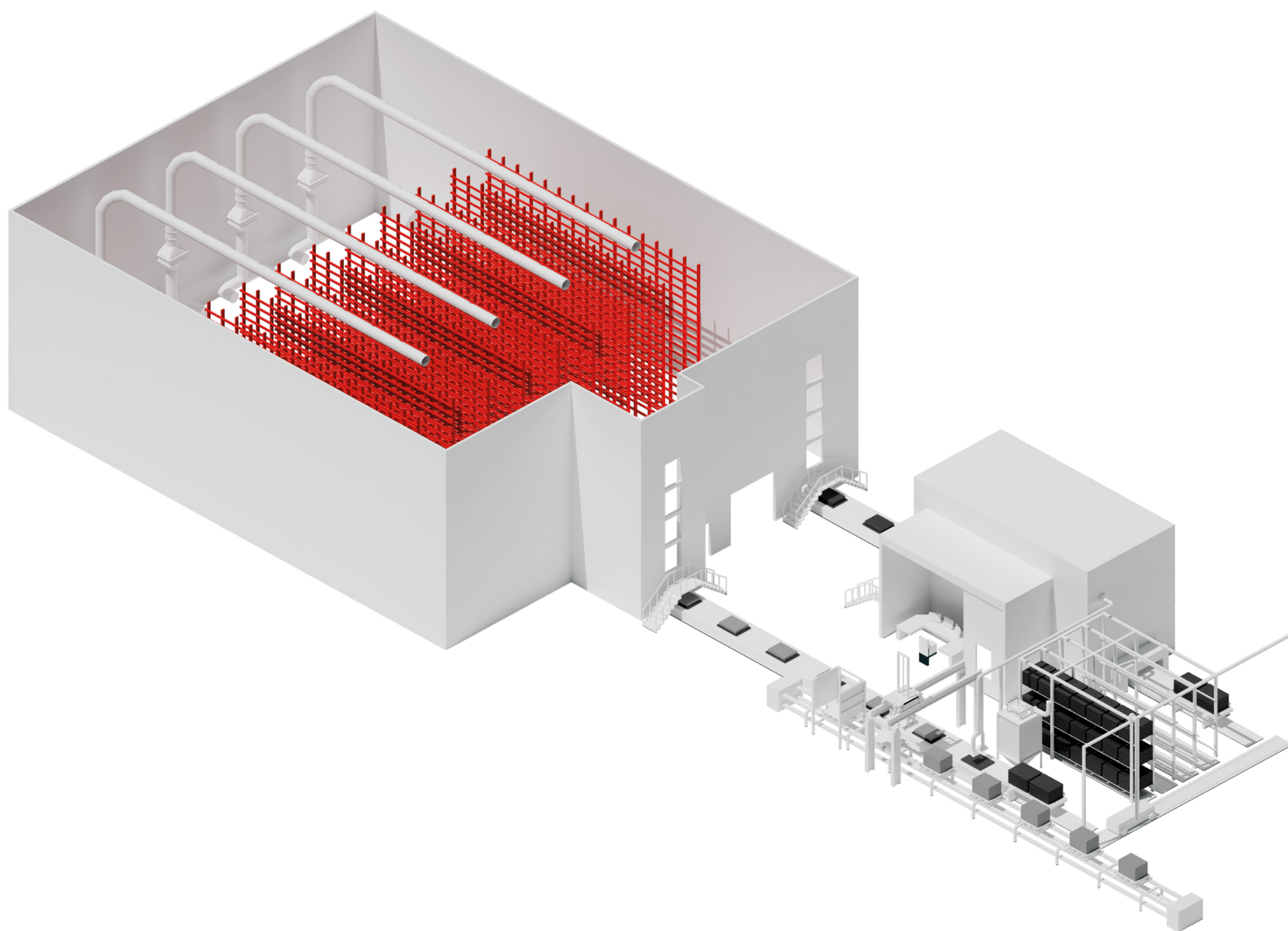

# Air Circulation System ProAir

## Product advantages

- Optimal circulation capacity for uniform temperature and humidity distribution
- Long service life due to high quality aluminum design
- Reduction of condensation



## Highlights



## Air Circulation System

Uniform curing conditions

The curing time and cement consumption can be reduced and the product quality increased by constant uniformity of temperature and humidity within the curing area.



## Highlights



### Separation Wall

Thermal separation of wet and dry sides using special wall elements.

- Standard design and individual planning and customization
- Design in different RAL-colors
- Comprehensive equipment program



## Highlights



### Delta-T

Energy-saving system for ProAir

Additional sensors measure the temperature difference between the upper and lower sensors in the curing rack. Enables the temperature difference to be regulated to a specific target value by adjusting the fan speed via a frequency converter.

- Reduction in electricity costs of up to 60%
- Reduced wear on the fans



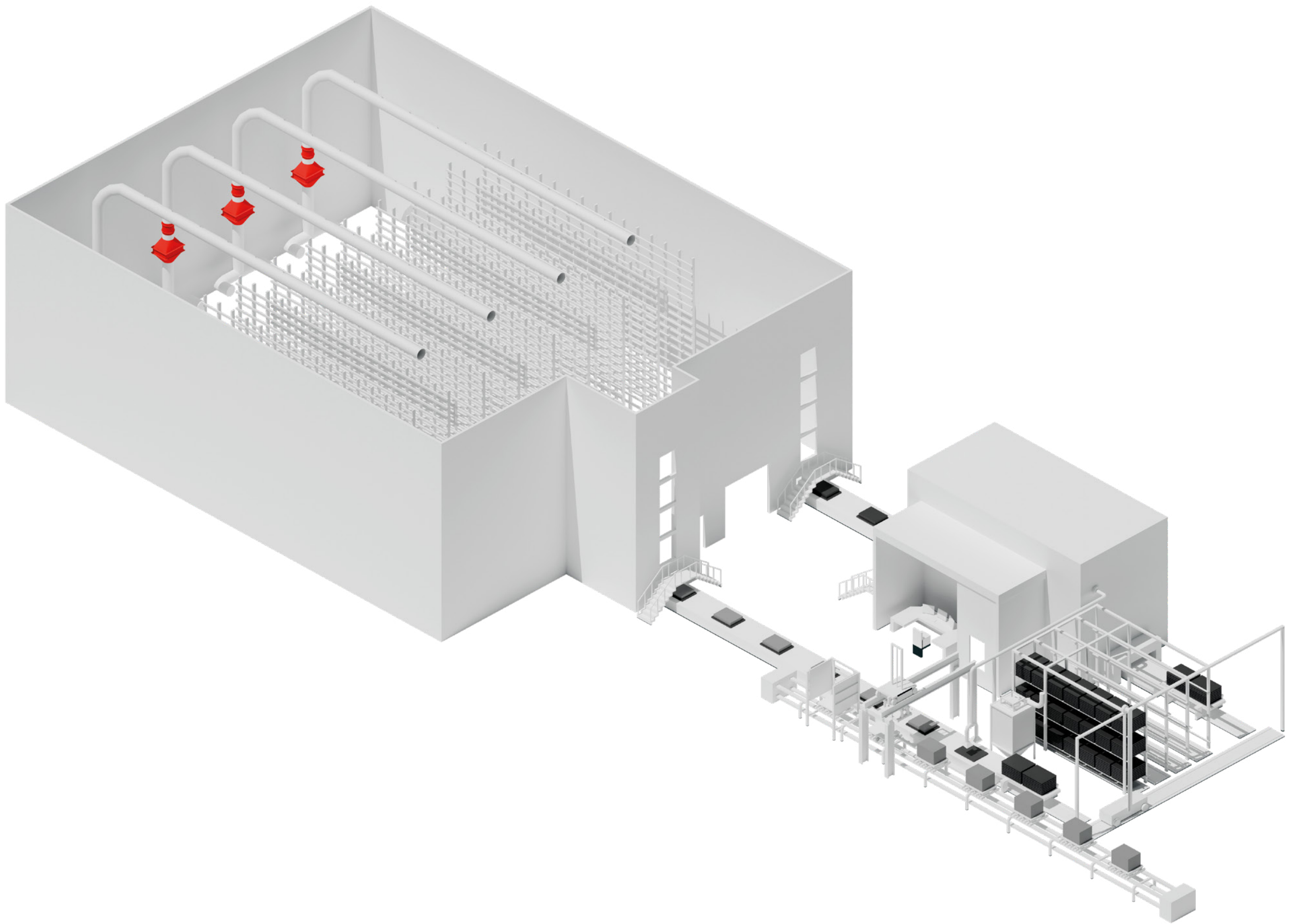

# Concrete Curing System ProCure

## Product advantages

Heating of the curing chamber for consistent quality results all year round and reduced curing times. Optionally with active humidification.

- More consistent color results
- Less efflorescence
- Reduced edge breakage
- Cement cost savings
- Maintenance-friendly and energy-efficient
- Incl. software solution ROTHO-Control



## Highlights



### ProCure

365 days a year - one climate

The ProCure Curing System ensures a uniform temperature within the curing area all year round.



## Highlights



### Heat exchanger

Sustainable use of heat sources

Cost-efficient heating system with maximum flexibility of the heat source.



## Highlights



### **Humidification station**

#### Plug and Play System

The low-maintenance high-pressure system provides particularly energy-saving and economical humidification of the curing climate. Plug and play system.



# Highlights

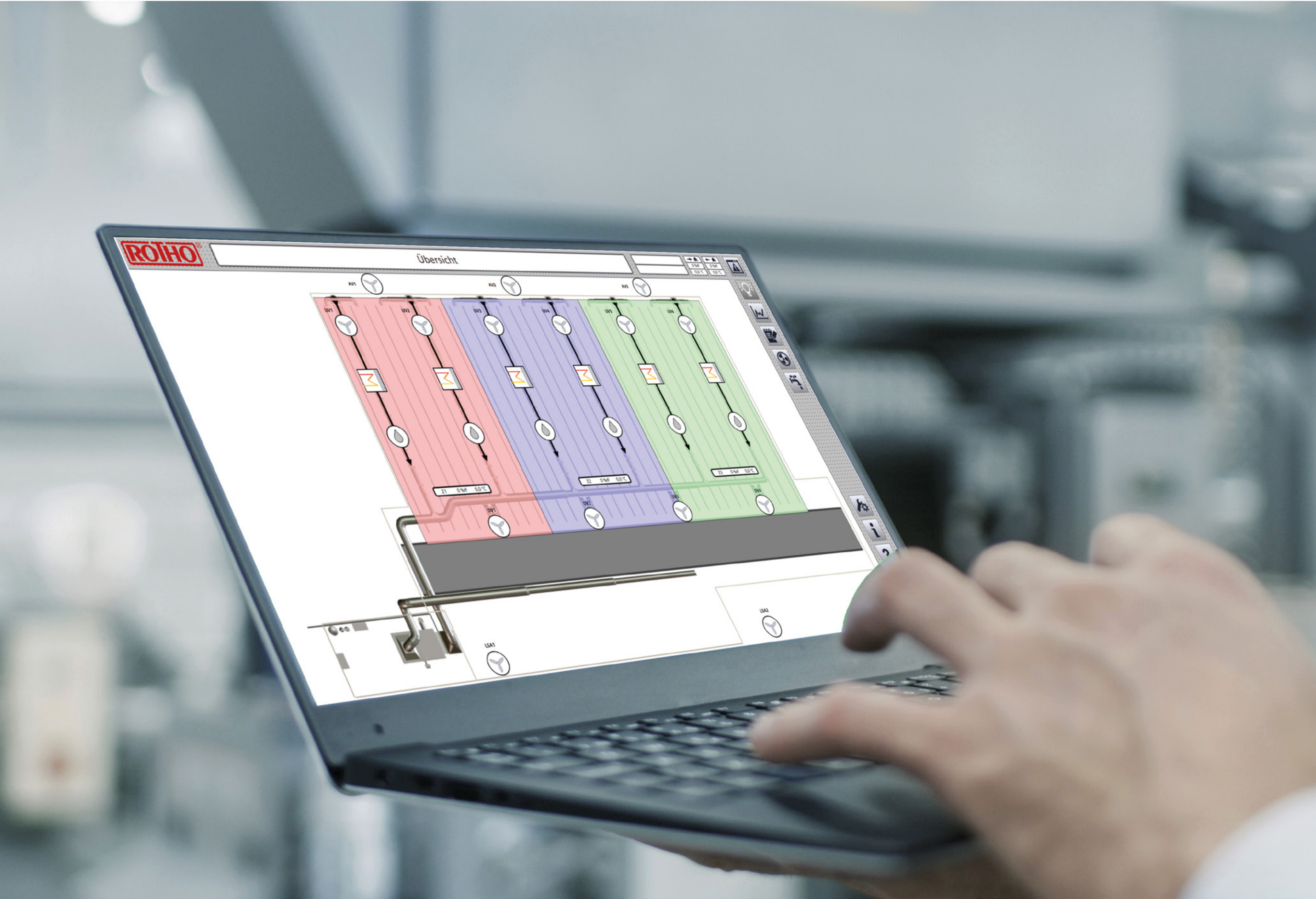

## ROTHO-Control

Software with intuitive user interface for zone control of the curing system.

Includes PC, Internet access, recording of historical data and the option of setting individual curing programs.



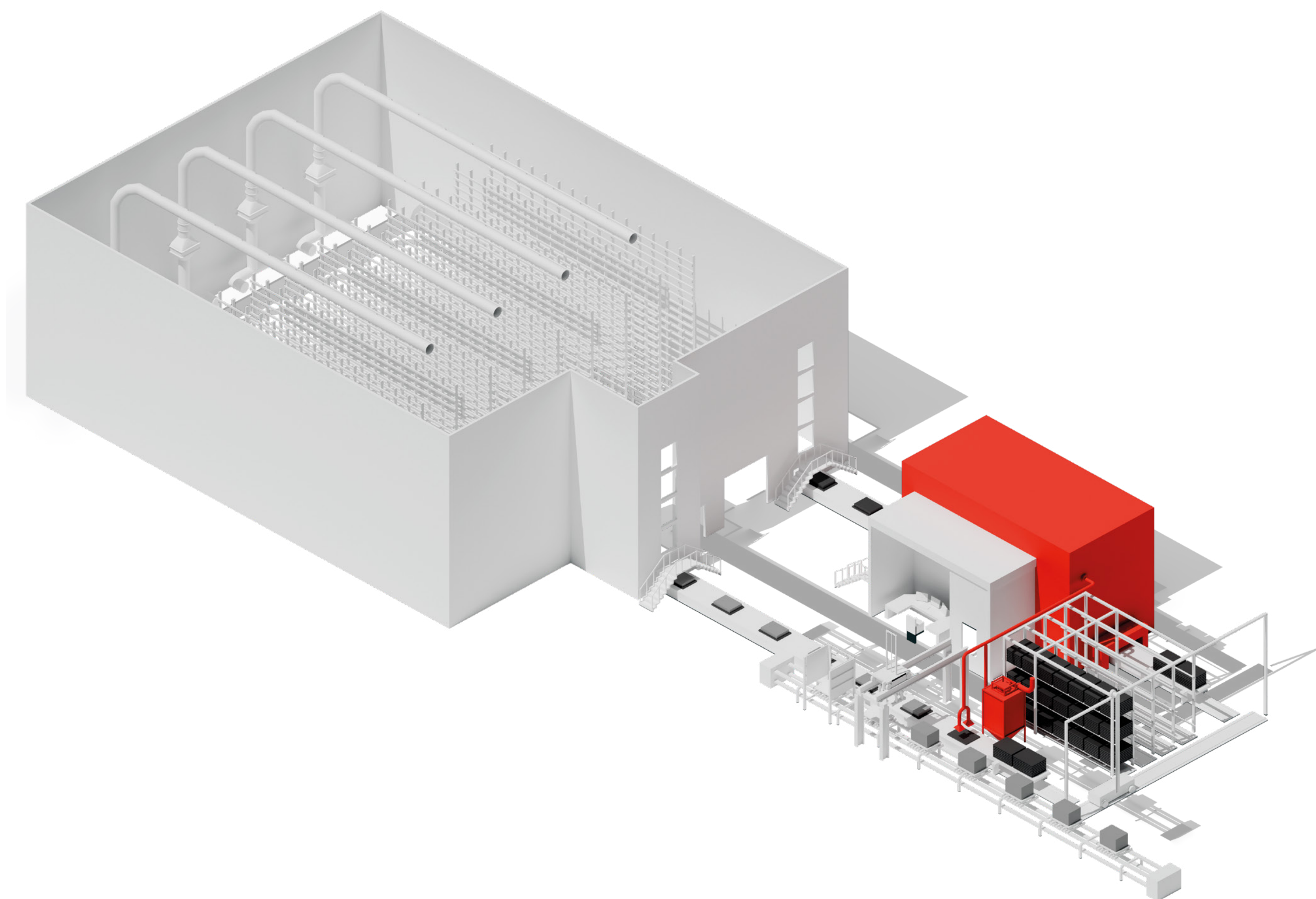

# Sound Protection & Dust Extraction

## Product advantages

Proven solutions to improve the quality of work. Compact, robust dust extraction system with replaceable filter units for dust reduction and effective sound protection solution to reduce the noise level of the concrete block machines. Easy to retrofit, even in existing production plants.



## Highlights



## Sound Protection

For the best working conditions

- Reduction of the noise level of the machines
- Comprehensive equipment program (Sliders, tunnels, windows, etc.)
- Individual design variants



# Highlights



## Dust Extraction

Compact, efficient dust extraction

- Electronic cleaning automatization
- Robust and durable filter system
- Maintenance-friendly
- Energy efficient



## Highlights



## Control & Switchboard Rooms

- With stilted floor for cable routing
- Comprehensive equipment program



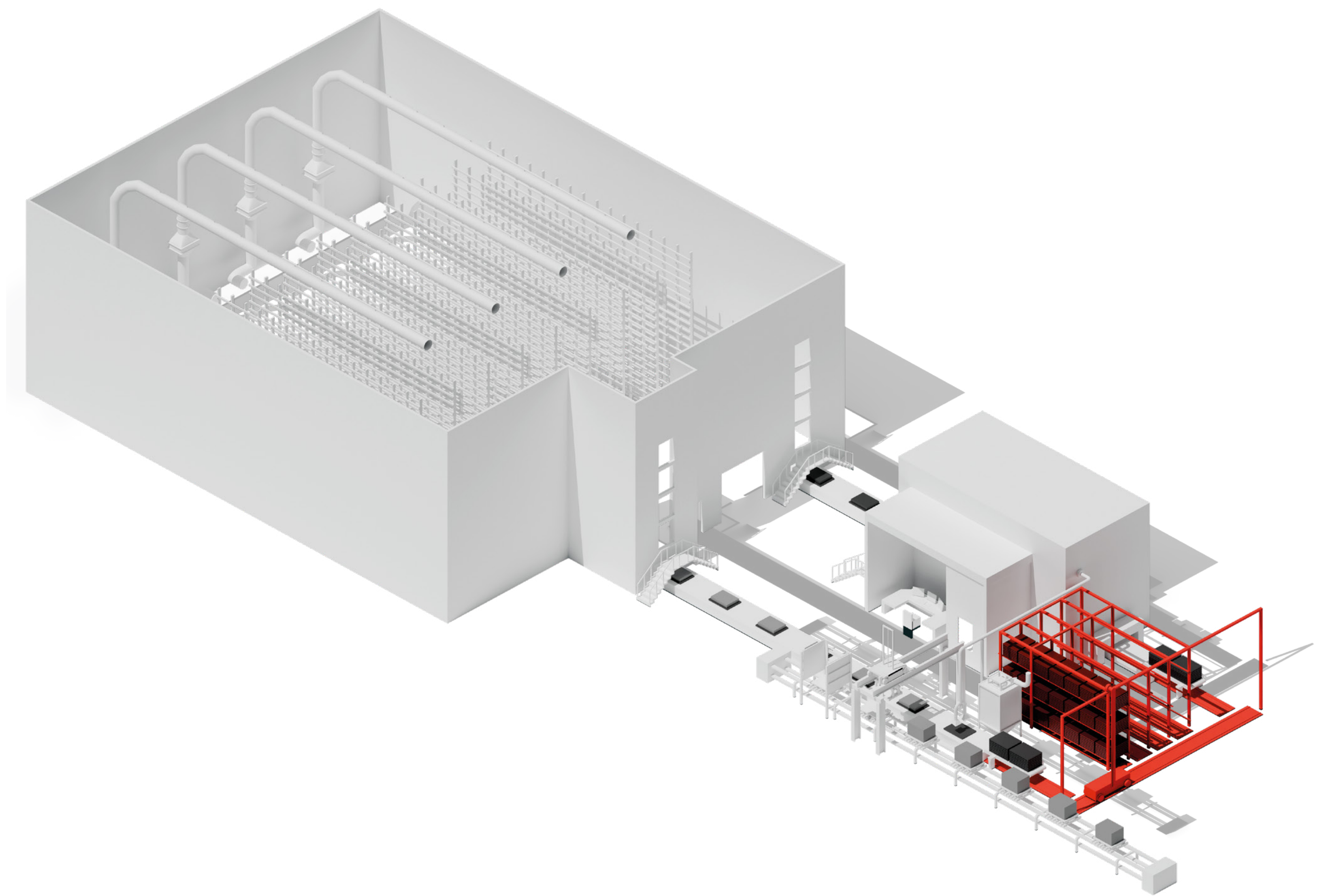

# Pallet Buffer & Mould Storage

## Product advantages

Process-integrated and highly stable storage systems for moulds and production boards.

- Individual solutions for the automatic and manual operation
- Also designed for extreme loads



## Highlights



### Pallet Buffer

Individual Solutions for the automatic and manual operation. Designed for the highest loads



## Highlights



## Mould Storage

Process-integrated and highly stable storage systems for dry and wetcast moulds.



## Highlights



## Pallets

Stackable pallets for concrete slabs and other products

- Optimal static design for every application
- Highest manufacturing precision
- Sturdy design for robust operation
- Durable thanks to galvanized surfaces



# ROTHO Assembly

Our assembly teams ensure best conditions during the project assembly and commissioning phase. Worldwide.





# ROTHO Service

## Worldwide

Our Service is on your side to ensure best conditions in your concrete block and paver plant.





## Service offerings:

- Telephone, email, web-conference and on-site service
- Service Contracts
- Spare Parts
- Modernization & upgrades
- Technical trainings
- Wide range of measurement and analysis tools & services
- Optimization consulting

**service@rotho.de** (E-Mail Service)

**(+49) 02735/788-788** (Help-Line)

**(+49) 0151/14311737** (Help-Line mobile)



# **Curing processes Optimize concrete products and increase efficiency. Made in Germany.**



## **Experience**

The average tenure of our employees is 25 years. This experience is enjoyed by our customers in more than 50 countries worldwide to operate their concrete block plants faster, more efficiently and in a secure environment..



## **Innovation**

In today's fast-paced, uncertain future, one thing is certain: the amount of data generated, evaluated and used will not decline. On the contrary, the number of sensors and algorithms will continue to rise within concrete block and paver plants. Even today, ROTHO offers unique intelligent systems that optimize concrete stone production plants using digital tools.





## Tradition

Neunkirchen, Siegerland - the home of ROTHO. We know our roots and have been a reliable partner for our customers for more than 100 years. ROTHO customers can be sure that spare parts and service will always be available in the future.



## Personable

Together we create the best conditions. Not just for concrete blocks. Reliable and trusting business relationships are even more important in an increasingly digitized world. The ROTHO business model is designed for long-term and sustainable success in close cooperation with our customers. We supply systems and projects that inspire our customers.





**Robert Thomas Metall- und  
Elektrowerke GmbH & Co. KG**

Hellerstr. 6 | 57290 Neunkirchen

Tel: (+49) 02735/788-0

E-Mail: [info@rotho.de](mailto:info@rotho.de)

[www.rotho.de](http://www.rotho.de)